

## Content

Konstantspannungs LED-Konvertern (CV) und Konstantstrom LED-Konvertern (CC) Constant Voltage (CV) and Constant Current (CC) LED Drivers.....	2
MDZ04-250IMR; MDZ04-350IMR; MDZ04-500IMR; MDZ04-700IMR .....	3
MDZ08-250IMR, MDZ08-350 IMR, MDZ08-500 IMR, MDZ08-700 IMR, MDZ08-1050 IMR, .....	4
MDZ15-250 IMR, MDZ15-350 IMR, MDZ15-500 IMR, MDZ15-700 IMR, MDZ15-1050 IMR, MDZ15-1400 IMR, .....	5
MDZ20-350IMR; MDZ20-500IMR; MDZ20-700IMR; MDZ20-1050IMR; MDZ20-1400IMR; MDZ20-12IVMR;.....	6
MDZ36-700IMR; MDZ36-1050IMR; MDZ36-1400IMR; MDZ36-12VMR.....	7
MDZ60-1500IMR; MDZ60-12VMR; MDZ60-24VMR .....	8
MDZ03-1MMR; MDZ04-1MV; MDZ03 -1MR; MDZ03 -1MMR; MDZ03 -2MR; MDZ03 -2MMR.	9
MDZ05-1MRVP, MDZ05-1MMRVP .....	10
MDZ15 -1MRT, MDZ15-1MMRT, MDZ15-2MRT; MDZ15-2MMRT.....	11
MDZ15 -1MRVT, MDZ15-1MMRVT .....	12
MDZ05 1E2MR MDZ12-1E1MR .....	13
MDZ03-1 MMRQ; MDZ03-2 MMRQ.....	14
MDZ06 1 MMRQ; MDZ10 1 MMRQ; MDZ08 2 MMRQ.....	15
MDZ03-1MRK; MDZ06-1MRK .....	16
MDZ09-1 MRK; MDZ12-1 MRK .....	17
MDZ16-1 MRK; MDZ20-1 MRK .....	18
MDZ08-1 MRF; MDZ12-1 MRF; MDZ20-1 MRF .....	19

## Konstantspannungs LED-Konvertern (CV) und Konstantstrom LED-Konvertern (CC)

### Constant Voltage (CV) and Constant Current (CC) LED Drivers

- Die eine konstante Spannung erhaltende LED-Konverter (CV) sind vorgesehen für LED mit geringer Leistung ( $<1W$ ). Die LED Dioden müssen mit einem Widerstand in Reihe geschaltet werden, um die Stromstärke einzuschränken.
- Die einen konstanten Strom erhaltenden LED-Konverter (CC) sind für LED mit großer Leistung vorgesehen ( $1W-5W$ ). In diesem Fall sind keine Widerstände die, die Stromstärke einschränken, notwendig.
- Constant voltage (CV) LED Drivers are used for low power LED's ( $<1W$ ). LED's must be mounted in series with resistors to limit the current.
- Constant current (CC) LED Drivers are used for high power LED's ( $1W - 5W$ ). Resistors are not necessary in this case.

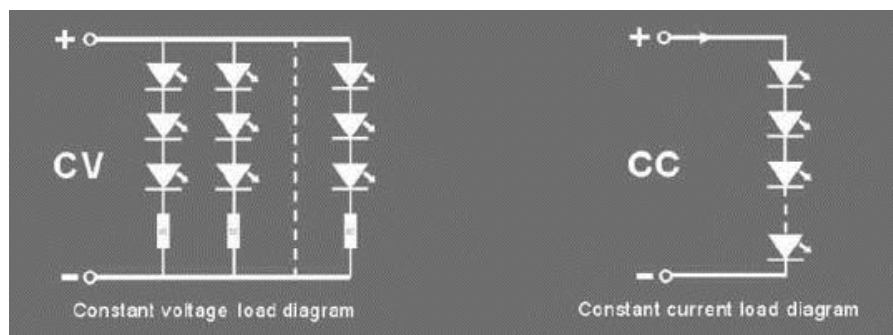

## Led Driver

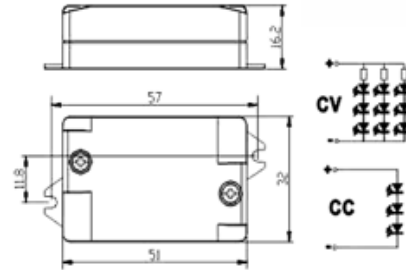

### Features

- IP20 independent LED Driver
- Class II protection against electric shock from direct and indirect contact.
- Constant Voltage 5V 12V 24V 36V,  
Constant Current 250mA/350mA/500mA/700mA
- Open circuit, short circuit, over load and over heat protection,
- Auto restart after fault conditions removal,
- Comply with IEC EMC and safety requirement,



### Standards

- EN 61347-1
- EN 61347-2-13
- UL 8750
- EN 55015
- EN 61000-3-2
- EN 61000-3-3
- EN 61547

Art.No.	Input	$\lambda$	Output		Ta(°C)	Tc(°C)	LxWxH	Approval
MDZ04-250IMR	100-240V 50/60Hz	>0.5	1-5*0.75W	250mA max 24V	45°C	80°C	51x32x16mm	UL/CUL/TUV
			DC 24V	max 170mA	45°C	80°C	51x32x16mm	UL/CUL/TUV
MDZ04-350IMR	100-240V 50/60Hz	>0.5	1-3*1W	350mA max 12V	45°C	80°C	51x32x16mm	UL/CUL/TUV
			DC 12V	max 350mA	45°C	80°C	51x32x16mm	UL/CUL/TUV
MDZ04-500IMR	100-240V 50/60Hz	>0.5	1-3*2W	500mA max 12V	45°C	80°C	51x32x16mm	UL/CUL/TUV
MDZ04-700IMR	100-240V 50/60Hz	>0.5	1-3W	700mA max 5V	45°C	80°C	51x32x16mm	UL/CUL/TUV
			DC 5V	max 700mA	45°C	80°C	51x32x16mm	UL/CUL/TUV

# MDZ08-250IMR, MDZ08-350 IMR, MDZ08-500 IMR, MDZ08-700 IMR, MDZ08-1050 IMR,

## Led Driver

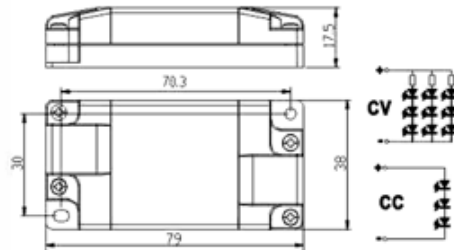
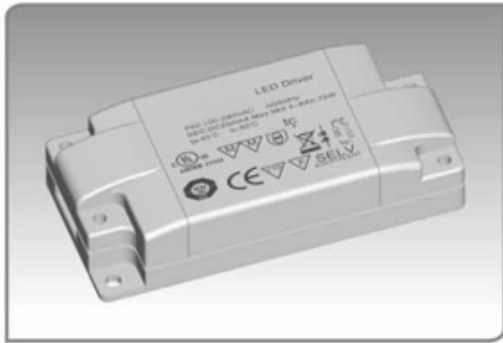

### Features

- IP20 independent LED Driver
- Class II protection against electric shock from direct and indirect contact.
- Constant Voltage 5V 12V 24V 36V,  
Constant Current 250mA/350mA/500mA/700mA/1050mA
- Open circuit, short circuit, over load and over heat protection,
- Auto restart after fault conditions removal,
- Comply with IEC EMC and safety requirement,



### Standards

EN 61347-1  
EN 61347-2-13  
UL 8750  
EN 55015  
EN 61000-3-2  
EN 61000-3-3  
EN 61547

Art.No.	Input	$\lambda$	Output	Ta(°C)	Tc(°C)	LxWxH	Approval	
MDZ08-250IMR	100-240V 50/60Hz	>0.5	4-8*0.75W	250mA	max 36V	45°C 80°C	79x38x18mm	UL/CUL/TUV
			DC36V	max 250mA	45°C 80°C	79x38x18mm	UL/CUL/TUV	
MDZ08-350IMR	100-240V 50/60Hz	>0.5	3-6*1W	350mA	max 24V	45°C 80°C	79x38x18mm	UL/CUL/TUV
			DC24V	max 350mA	45°C 80°C	79x38x18mm	UL/CUL/TUV	
MDZ08-500IMR	100-240V 50/60Hz	>0.5	1-4*2W	500mA	max 16V	45°C 80°C	79x38x18mm	UL/CUL/TUV
MDZ08-700IMR	100-240V 50/60Hz	>0.5	1-3*3W	700mA	max 12V	45°C 80°C	79x38x18mm	UL/CUL/TUV
			DC 12V	max 700mA	45°C 80°C	79x38x18mm	UL/CUL/TUV	
MDZ08-1050IMR	100-240V 50/60Hz	>0.5	1-2*4W	1050mA	8V	45°C 80°C	79x38x18mm	UL/CUL/TUV

**MDZ15-250 IMR, MDZ15-350 IMR, MDZ15-500 IMR, MDZ15-700 IMR, MDZ15-1050 IMR, MDZ15-1400 IMR,**

**Led Driver**

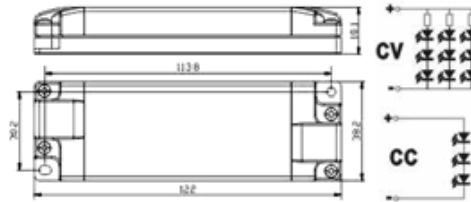

**Features**

- IP20 independent LED Driver
- Class II protection against electric shock from direct and indirect contact.
- Constant Voltage 5V 12V 24V 36V,  
Constant Current 250mA/350mA/500mA/700mA/1050mA/1400mA
- Open circuit, short circuit, over load and over heat protection,
- Auto restart after fault conditions removal,
- Comply with IEC EMC and safety requirement,



**Standards**

- EN 61347-1
- EN 61347-2-13
- UL 8750
- EN 55015
- EN 61000-3-2
- EN 61000-3-3
- EN 61547

Art.No.	Input	$\lambda$	Output	Ta(°C)	Tc(°C)	LxWxH	Approval
MDZ15-250IMR	100-240V 50/60Hz	>0.9	6-15*0.75W 250mA max 60V	45°C	80°C	122x38x18mm	UL/CUL/TUV
MDZ15-350IMR	100-240V 50/60Hz	>0.9	5-12*1W 350mA max 48V	45°C	80°C	122x38x18mm	UL/CUL/TUV
MDZ15-500IMR	100-240V 50/60Hz	>0.9	4-9*2W 500mA max 36V	45°C	80°C	122x38x18mm	UL/CUL/TUV
			DC36V max 420mA	45°C	80°C	122x38x18mm	UL/CUL/TUV
MDZ15-700IMR	100-240V 50/60Hz	>0.9	3-6*3W 700mA max 24V	45°C	80°C	122x38x18mm	UL/CUL/TUV
			DC24V max 625mA	45°C	80°C	122x38x18mm	UL/CUL/TUV
MDZ15-1050IMR	100-240V 50/60Hz	>0.9	1-4*4W 1050mA max 16V	45°C	80°C	122x38x18mm	UL/CUL/TUV
MDZ15-1400IMR	100-240V 50/60Hz	>0.9	1-3*5W 1400mA max 12V	45°C	80°C	122x38x18mm	UL/CUL/TUV
			DC12V max 1250mA	45°C	80°C	122x38x18mm	UL/CUL/TUV

**MDZ20-350IMR; MDZ20-500IMR; MDZ20-700IMR; MDZ20-1050IMR;  
MDZ20-1400IMR; MDZ20-12IVMR;**

**Led Driver**

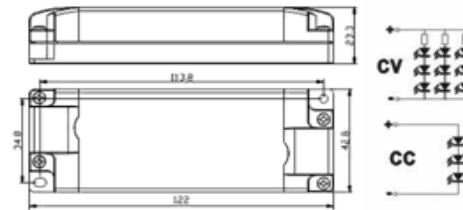
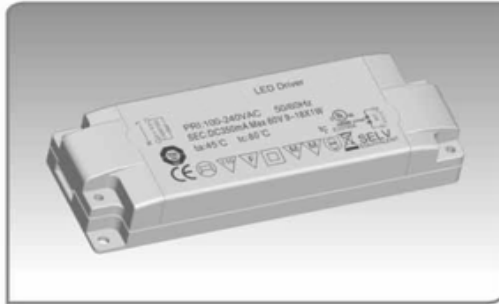

**Features**

- IP 20 independent LED Driver
- Class II protection against electric shock from direct and indirect contact.
- Constant Voltage 5V 12V 24V 36V,
- Constant Current 350mA/500mA/700mA/1050mA/1400mA
- Open circuit, short circuit, over load and over heat protection,
- Auto restart after fault conditions removal,
- Comply with IEC EMC and safety requirement,



**Standards**

- EN 61347-1
- EN 61347-2-13
- UL 8750
- EN 55015
- EN 61000-3-2
- EN 61000-3-3
- EN 61547

Art.No.	Input	$\lambda$	Output	Ta(°C)	Tc(°C)	LxWxH	Approval
MDZ20-350IMR	100-240V 50/60Hz	>0.9	9-18*1W 350mA max 60V	45°C	80°C	122x42x23mm	UL/CUL/TUV
MDZ20-500IMR	100-240V 50/60Hz	>0.9	8-15*2W 500mA max 48V	45°C	80°C	122x42x23mm	UL/CUL/TUV
MDZ20-700IMR	100-240V 50/60Hz	>0.9	4-9*3W 700mA max 36V	45°C	80°C	122x42x23mm	UL/CUL/TUV
			DC36V max 550mA	45°C	80°C	122x42x23mm	UL/CUL/TUV
MDZ20-1050IMR	100-240V 50/60Hz	>0.9	1-5*4W 1050mA max 24V	45°C	80°C	122x42x23mm	UL/CUL/TUV
			DC24V max 830mA	45°C	80°C	122x42x23mm	UL/CUL/TUV
MDZ20-1400IMR	100-240V 50/60Hz	>0.9	1-4*5W 1400mA max 1.6A	45°C	80°C	122x42x23mm	UL/CUL/TUV
MDZ20-12IVMR	100-240V 50/60Hz	>0.9	DC12V max 1.6A	45°C	80°C	122x42x23mm	UL/CUL/TUV

## Led Driver

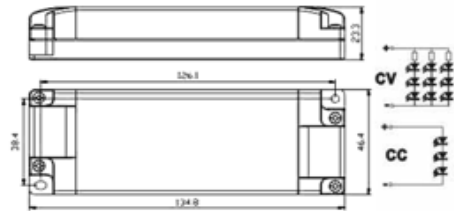
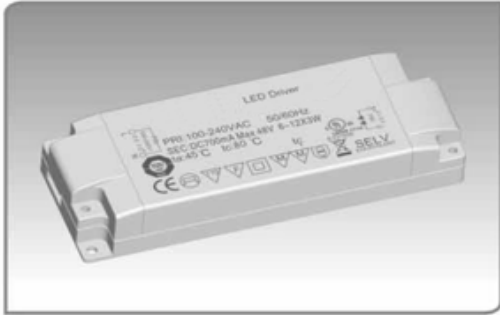

**Features**

- IP20 independent LED Driver
- Class II protection against electric shock from direct and indirect contact.
- Constant Voltage 5V 12V 24V 36V,  
Constant Current 700mA/1050mA/1400mA
- Open circuit, short circuit, over load and over heat protection.
- Auto restart after fault conditions removal,
- Comply with IEC EMC and safety requirement.



**Standards**

- EN 61347-1
- EN 61347-2-13
- UL 8750
- EN 55015
- EN 61000-3-2
- EN 61000-3-3
- EN 61547

Art.No.	Input	$\lambda$	Output		Ta(°C)	Tc(°C)	LxWxH	Approval
MDZ36-700IMR	100-240V 50/60Hz	>0.9	6-12*3W	700mA max 48V	45°C	80°C	135x46x23mm	UL/CUL/TUV
MDZ36-1050IMR	100-240V 50/60Hz	>0.9	5-10*4W	1050mA max 36V	45°C	80°C	135x46x23mm	UL/CUL/TUV
			DC36V	max 1050mA	45°C	80°C	135x46x23mm	UL/CUL/TUV
MDZ36-1400IMR	100-240V 50/60Hz	>0.9	3-7*5W	1400mA max 24V	45°C	80°C	135x46x23mm	UL/CUL/TUV
			DC24V	max 1400mA	45°C	80°C	135x46x23mm	UL/CUL/TUV
MDZ36-12VMR	100-240V 50/60Hz	>0.9	DC12V	max 3A	45°C	80°C	135x46x23mm	UL/CUL/TUV

## Led Driver



### Features

- IP20 independent LED Driver
- Class II protection against electric shock from direct and indirect contact.
- Constant Voltage 5V 12V 24V 36V,  
Constant Current 1500mA max
- Open circuit, short circuit, over load and over heat protection,
- Auto restart after fault conditions removal,
- Comply with IEC EMC and safety requirement.



### Standards

- EN 61347-1
- EN 61347-2-13
- UL 8750
- EN 55015
- EN 61000-3-2
- EN 61000-3-3
- EN 61547

Art.No.	Input	$\lambda$	Output	Ta(°C)	Tc(°C)	LxWxH	Approval		
MDZ60-1500IMR	100-240V 50/60Hz	>0.9	4-10*5W	1500mA	max 36V	45°C	80°C	163x48x28mm	UL/CUL/TUV
			DC36V	max 1500mA	45°C	80°C	163x48x28mm	UL/CUL/TUV	
MDZ60-12VMR	100-240V 50/60Hz	>0.9	DC12V	max 5A	45°C	80°C	163x48x28mm	UL/CUL/TUV	
MDZ60-24VMR	100-240V 50/60Hz	>0.9	DC24V	max 2.5A	45°C	80°C	163x48x28mm	UL/CUL/TUV	



MDZ03-1MMR; MDZ04-1MV; MDZ03 -1MR; MDZ03 -1MMR; MDZ03 -2MR; MDZ03 -2MMR

LED Driver

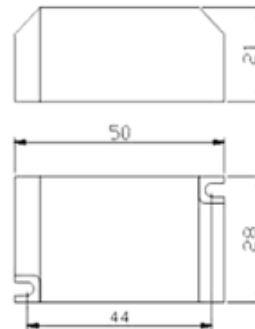

Features

- Built-in LED Driver
- DC 12V constant voltage output and Max. 3W,4W load.
- 350mA 1 3x1W and 700mA 3x1W constant current LED driver
- Open circuit, short circuit, over load and over heat protection.
- Auto restart after fault conditions removal,
- With 20cm length flying leads,
- Comply with IEC EMC and safety requirement,
- The latest TUV standard approval



Standards

- EN 61347-1
- EN 61347-2-13
- EN 55015
- EN 61000-3-2
- EN 61000-3-3
- EN 61547

Constant Voltage

Model NO.	Input voltage	Constant output voltage	Load	$\lambda$	Ta	Tc	LxWxH	Approval
MDZ03-1MMRV	100-240V 50/60Hz	DC 12V	0-3W	0.5	45°C	80°C	50x28x21mm	TUV
MDZ04-1MRV	220-240V 50/60Hz	DC 12V	0-4W	0.5	45°C	80°C	50x28x21mm	TUV

Constant Current

Model NO.	Input voltage	Constant output current	Max output voltage	Load	$\lambda$	Ta	Tc	LxWxH	Approval
MDZ03-1MR	220-240V 50/60Hz	DC 350mA	12V	1..3x1W	0.5	45°C	80°C	50x28x21mm	TUV
MDZ03-1MMR	100-240V 50/60Hz	DC 350mA	12V	1..3x1W	0.5	45°C	80°C	50x28x21mm	TUV
MDZ03-2MR	220-240V 50/60Hz	DC 700mA	4.5V	1x3W	0.5	45°C	80°C	50x28x21mm	TUV
MDZ03-2MMR	100-240V 50/60Hz	DC 700mA	4.5V	1x3W	0.5	45°C	80°C	50x28x21mm	TUV

## MDZ05-1MRVP, MDZ05-1MMRVP

### Constant Voltage LED Driver

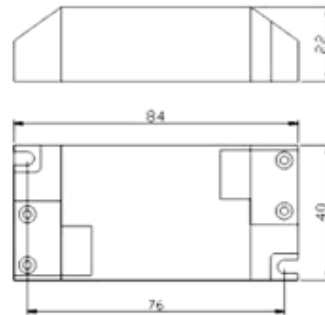

#### Features

- IP20 independent LED Driver
- Class II protection against electric shock from direct and indirect contact.
- Constant Voltage 12V output and Max. 5W load.
- Open circuit, short circuit, over load and over heat protection,
- Auto restart after fault conditions removal,
- Comply with IEC EMC and safety requirement,
- The latest TUV standard approval



#### Standards

EN 61347-1  
 EN 61347-2-13  
 EN 55015  
 EN 61000-3-2  
 EN 61000-3-3  
 EN 61547

Model NO.	Input voltage	Constant output voltage	Load	$\lambda$	T <sub>a</sub>	T <sub>c</sub>	LxWxH	Approval
MDZ05-1MRVP	220-240V 50/60Hz	DC 12V	0-5W	0.5	45°C	80°C	83x40x22mm	TUV
MDZ05-1MMRVP	100-240V 50/60Hz	DC 12V	0-5W	0.5	45°C	80°C	83x40x22mm	TUV

MDZ15 -1MRT, MDZ15-1MMRT, ; MDZ15-2MRT; MDZ15-2MMRT

**Constant Current LED Driver**

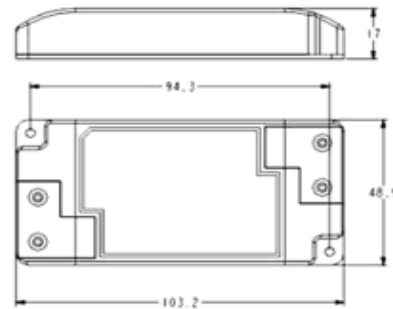

The height is only 17 mm, suitable for furniture installation.

**Features**

- IP20 independent LED Driver
- Class II protection against electric shock from direct and indirect contact.
- 350mA/700mA constant current output and Max. 15W load.
- Open circuit, short circuit, over load and over heat protection.
- Auto restart after fault conditions removal.
- Comply with IEC EMC and safety requirement.
- The latest TUV standard approval



**Standards**

- EN 61347-1
- EN 61347-2-13
- EN 55015
- EN 61000-3-2
- EN 61000-3-3
- EN 61547



Model NO.	Input voltage	Constant output current	Max output voltage	Load	$\lambda$	Ta	Tc	LxWxH	Approval
MDZ15-1MRT	220-240V 50/60Hz	DC 350mA	55V	6.15x1W	0.5	45°C	80°C	103x49x17mm	TUV
MDZ15-1MMRT	100-240V 50/60Hz	DC 350mA	55V	6.15x1W	0.5	45°C	80°C	103x49x17mm	TUV
MDZ15-2MRT	220-240V 50/60Hz	DC24V/700mA	24V	3.6x3W	0.5	45°C	80°C	103x49x17mm	TUV
MDZ15-2MMRT	100-240V 50/60Hz	DC24V/700mA	24V	3.6x3W	0.5	45°C	80°C	103x49x17mm	TUV

## MDZ15 -1MRVT, MDZ15-1MMRVT

### Constant Voltage LED Driver

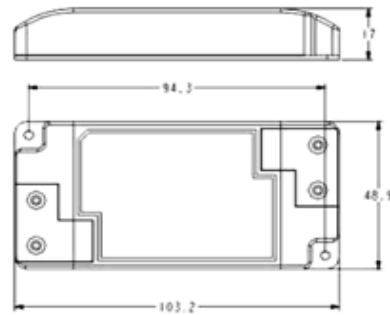

The height is only **17** mm, suitable for furniture installation.

#### Features

- IP20 independent LED Driver
- Class II protection against electric shock from direct and indirect contact.
- Constant Voltage 12V output and Max.15W load.
- Open circuit, short circuit, over load and over heat protection,
- Auto restart after fault conditions removal,
- Comply with IEC EMC and safety requirement,
- The latest TUV standard approval



#### Standards

- EN 61347-1
- EN 61347-2-13
- EN 55015
- EN 61000-3-2
- EN 61000-3-3
- EN 61547

Model NO.	Input voltage	Constant output voltage	Load	$\lambda$	Ta	Tc	LxWxH	Approval
MDZ15-1MRVT	220-240V 50/60Hz	DC 12V	0-15W	0.5	45°C	80°C	103x49x17mm	TUV
MDZ15-1MMRVT	100-240V 50/60Hz	DC 12V	0-15W	0.5	45°C	80°C	103x49x17mm	TUV



## Constant Voltage LED Driver

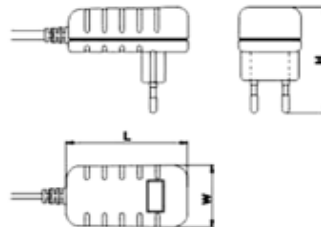

### Features

- IP20 independent LED Driver
- Class II protection against electric shock from direct and indirect contact.
- Constant Voltage 12V output and Max.12W load.
- Open circuit,short circuit,over load and over heat protection,
- Auto restart after fault conditions removal,
- Comply with IEC EMC and safety requirement,

### Standards

- EN 61347-1
- EN 61347-2-13
- EN 55015
- EN 61000-3-2
- EN 61000-3-3
- EN 61547

Model NO.	Input voltage	Constant output voltage	Load	$\lambda$	Ta	Tc	LxWxH	Approval
MDZ05-1E2MR	100-240V 50/60Hz	DC 12V	0-5W	0.5	45°C	80°C	72x38x46mm	TUV
MDZ12-1E1MR	100-240V 50/60Hz	DC 12V	1-12W	0.5	45°C	80°C	72x38x46mm	TUV

## Constant Current LED Driver

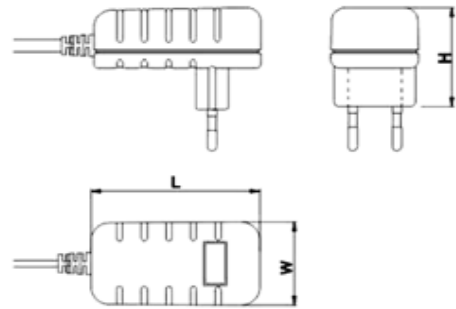

### Features

- IP20 independent LED Driver
- Class II protection against electric shock from direct and indirect contact.
- 350mA/700mA constant current output and Max. 3W load.
- Open circuit, short circuit, over load and over heat protection.
- Auto restart after fault conditions removal.
- Comply with IEC EMC and safety requirement.
- The latest TUV standard approval



### Standards

- EN 61347-1
- EN 61347-2-13
- EN 55015
- EN 61000-3-2
- EN 61000-3-3
- EN 61547

Model NO.	Input voltage	Constant output current	Max output voltage	Load	$\lambda$	Ta	Tc	LxWxH	Approval
MDZ03-1MMRQ	100-240V 50/60Hz	DC 350mA	12V	1..3x1W	0.5	45°C	80°C	54x34x43mm	TUV
MDZ03-2MMRQ	100-240V 50/60Hz	DC 700mA	4.5V	1x3W	0.5	45°C	80°C	54x34x43mm	TUV

## Constant Current LED Driver

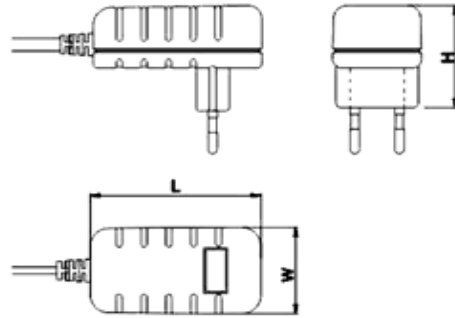

### Features

- IP20 independent LED Driver
- Class II protection against electric shock from direct and indirect contact.
- 350mA/700mA constant current output and Max. 12W load.
- Open circuit, short circuit, over load and over heat protection,
- Auto restart after fault conditions removal,
- Comply with IEC EMC and safety requirement,
- The latest TUV standard approval



### Standards

- EN 61347-1
- EN 61347-2-13
- EN 55015
- EN 61000-3-2
- EN 61000-3-3
- EN 61547

Model NO.	Input voltage	Constant output current	Max output voltage	Load	$\lambda$	Ta	Tc	LxWxH	Approval
MDZ06-1 MMRQ	100-240V 50/60Hz	DC 350mA	22V	3..6x1W	0.5	45°C	80°C	72x38x46mm	TUV
MDZ10-1 MMRQ	100-240V 50/60Hz	DC 350mA	36V	6 10x1W	0.5	45°C	80°C	72x38x46mm	TUV
MDZ08-2 MMRQ	100-240V 50/60Hz	DC 700mA	15V	2.4x3W	0.5	45°C	80°C	72x38x46mm	TUV

## Constant Current LED Driver

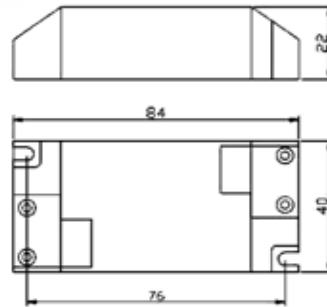

### Features

- IP20 independent LED Driver
- Class II protection against electric shock from direct and indirect contact.
- 350mA constant current output and Max. 6W load.
- Open circuit, short circuit, over load and over heat protection,
- Auto restart after fault conditions removal,
- Comply with IEC EMC and safety requirement,
- The latest TUV standard approval



### Standards

- EN 61347-1
- EN 61347-2-13
- EN 55015
- EN 61000-3-2
- EN 61000-3-3
- EN 61547



Model NO.	Input voltage	Constant output current	Max output voltage	Load	$\lambda$	Ta	Tc	LxWxH	Approval
MDZ03-1MRK	220-240V 50/60Hz	DC 350mA	12V	3x1W	0.5	45°C	80°C	83x40x22mm	TUV
MDZ06-1MRK	220-240V 50/60Hz	DC 350mA	22V	6x1W	0.5	45°C	80°C	83x40x22mm	TUV



## Constant Current LED Driver

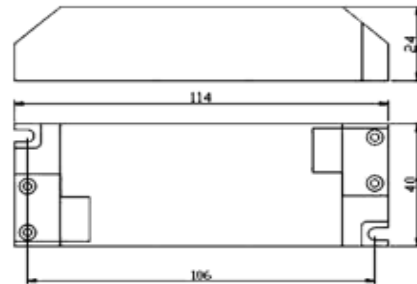

### Features

- IP20 independent LED Driver
- Class II protection against electric shock from direct and indirect contact.
- 350mA constant current output and Max. 12W load.
- Open circuit, short circuit, over load and over heat protection,
- Auto restart after fault conditions removal,
- Comply with IEC EMC and safety requirement,
- The latest TUV standard approval



### Standards

EN 61347-1  
 EN 61347-2-13  
 EN 55015  
 EN 61000-3-2  
 EN 61000-3-3  
 EN 61547

Model NO.	Input voltage	Constant output current	Max output voltage	Load	$\lambda$	Ta	Tc	LxWxH	Approval
MDZ09-1 MRK	220-240V 50/60Hz	DC 350mA	35V	9x1W	0.5	45°C	80°C	114x40x24mm	TUV
MDZ12-1 MRK	220-240V 50/60Hz	DC 350mA	45V	12x1W	0.5	45°C	80°C	114x40x24mm	TUV



## Constant Current LED Driver

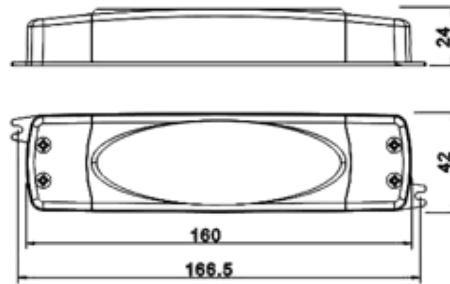

### Features

- IP20 independent LED Driver
- Class II protection against electric shock from direct and indirect contact.
- 350mA constant current output and Max. 20W load.
- Open circuit, short circuit, over load and over heat protection,
- Auto restart after fault conditions removal,
- Comply with IEC EMC and safety requirement,
- The latest TUV standard approval



### Standards

- EN 61347-1
- EN 61347-2-13
- EN 55015
- EN 61000-3-2
- EN 61000-3-3
- EN 61547



Model NO.	Input voltage	Constant output current	Max output voltage	Load	$\lambda$	Ta	Tc	LxWxH	Approval
MDZ16-1 MRK	220-240V 50/60Hz	DC 350mA	55V	16x1W	0.5	45°C	80°C	160x42x24mm	TUV
MDZ20-1 MRK	220-240V 50/60Hz	DC 350mA	70V	20x1W	0.5	45°C	80°C	160x42x24mm	TUV

## Constant Current LED Driver

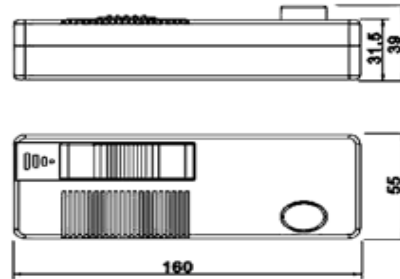

### Features

- IP20 independent LED Driver
- Class II protection against electric shock from direct and indirect contact.
- 350mA constant current output and Max. 20W load.
- Open circuit, short circuit, over load and over heat protection.
- Auto restart after fault conditions removal.
- Comply with IEC EMC and safety requirement.
- The latest TUV standard approval



### Standards

- EN 61347-1
- EN 61347-2-13
- EN 55015
- EN 61000-3-2
- EN 61000-3-3
- EN 61547

Model NO.	Input voltage	Constant output current	Max output voltage	Load	$\lambda$	Ta	Tc	LxWxH	Approval
MDZ08-1 MRF	220-240V 50/60Hz	DC 350mA	28V	8x1W	0.5	45°C	80°C	161x55x32mm	TUV
MDZ12-1 MRF	220-240V 50/60Hz	DC 350mA	42V	12x1W	0.5	45°C	80°C	161x55x32mm	TUV
MDZ20-1 MRF	220-240V 50/60Hz	DC 350mA	70V	20x1W	0.9	45°C	80°C	161x55x32mm	TUV